

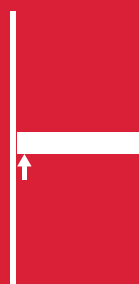

# Triade Mini



WOOD AND  
GLASS  
SHELVING  
SYSTEMS



# SYMBOLS AND FINISHES LEGEND

## SYMBOLS

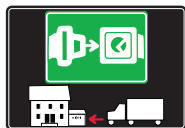

= SHELF SAFELY LOCKED DURING  
TRANSPORTATION AND AT HOME.



= ANTI-TURNOVER LOCKING SYSTEM



= NORMS / PATENTS



= PHILLIPS / POZIDRIV



= NEWTON



= PART.NO



= HEXAGONAL SOCKET



= FRICTION



= PCS. PER PACKAGE



= BLADE SLOT



= AUTOMATIC



= COMBI SLOT



= DROP DOWN



= CAPACITY LOADING



= COUNTERSUNK HEAD



= WOOD / GLASS  
THICKNESS



= PAN HEAD



= STANDARD HINGE



= HOLE DIAMETER



= FLANGE HEAD



= KIMANA HINGE



= DIAMETER



= FLAT HEAD



= FLAP HINGE



= LENGTH



= TRILOBULAR SCREW



= WITH SPRING



= HEIGHT



= SELF-TAPPING SCREW



= WITHOUT SPRING



= RIGHT VERSION



= EURO THREAD



= REVERSED SPRING



= LEFT VERSION



= METRIC THREAD



= SETTING CODE



= PRE-INSERTED SCREW



= FOR ROUND TUBE



= PCS. PER PAD



= PRE-INSERTED SCREW  
AND SPREADING BUSH



= FOR OVAL TUBE



= CUT ON REQUEST



= WITH BUFFER



= SELF ADHESIVE



= WITH MAGNET



= WITH FLANGE

NOTE: Printing errors and omissions may exist despite our best efforts to ensure accuracy. We reserve the right to alter specifications without notice.

## MATERIALS

<b>ZA</b> = Zinc Alloy	<b>ST</b> = Steel	<b>HSS</b> = High Speed Steel	<b>BR</b> = Brass	<b>ABS</b> = Acrylonitrile Butadiene Styrene
<b>ZAnk</b> = Nickel-plated Zinc Alloy	<b>STzk</b> = Zinc-plated Steel	<b>AL</b> = Aluminium	<b>WD</b> = Wood	<b>EVA</b> = Ethylene Vinyl Acetate

<b>EP</b> = <b>ENGINEERING PLASTIC</b>	<b>+ EP</b> = other engineering plastic available on request	<b>SR</b> = <b>SOFT RUBBER</b>	<b>+ SR</b> = other soft rubber available on request
--	--	--------------------------------	--

<b>EPn</b> = Natural Engineering Plastic	<b>EPc</b> = Clear Engineering Plastic	<b>SRn</b> = Natural Soft Rubber
<b>EPw</b> = White Engineering Plastic	<b>EPg</b> = Grey Engineering Plastic	<b>SRw</b> = White Soft Rubber
<b>EPwg</b> = Water Green Engineering Plastic		<b>SRb</b> = Black Soft Rubber



## FINISHES



**+ OTHER FINISHES AVAILABLE ON REQUEST**

PART. NO	FINISHES	PART. NO	FINISHES	PART. NO	FINISHES
<b>AA</b>	Natural	<b>IN</b>	Grey met. 26	<b>UT</b>	T-Met 9007
<b>AB</b>	White	<b>JB</b>	Bright Aluminium	<b>UZ</b>	T-Met
<b>AC</b>	Opal White	<b>JC</b>	Aluminium - Chrome	<b>WA</b>	Bronzed
<b>AE</b>	White 9010	<b>JD</b>	Matt Aluminium	<b>WI</b>	Burnished
<b>AK</b>	Champagne	<b>JE</b>	Satin-finished Aluminium	<b>XD</b>	Satin-finished Steel
<b>AL</b>	Ivory	<b>JF</b>	Aluminium - Brass	<b>YA</b>	Nickel-plated
<b>EA</b>	Black	<b>JG</b>	Aluminium 5	<b>YB</b>	Bright Nickel-plated
<b>EB</b>	Glossy Black	<b>JL</b>	Aluminium PE 11	<b>YC</b>	Matt Nickel-plated
<b>EC</b>	Matt Black	<b>JM</b>	Aluminium RAL 9006	<b>YD</b>	Satin-finished Nickel-plated
<b>EE</b>	Anthracite	<b>KA</b>	Chrome	<b>YQ</b>	Black Nickel
<b>EW</b>	Grey 9007	<b>KB</b>	Bright Chrome	<b>Z9</b>	Black Zinc
<b>FU</b>	Gunmetal	<b>KC</b>	Matt Chrome	<b>ZA</b>	Zinc alloy
<b>FV</b>	Gunmetal V52	<b>MA</b>	Brown	<b>ZN</b>	Zinc-plated
<b>GR</b>	Raw	<b>MB</b>	Light Brown 1	<b>ZQ</b>	Bright Gold
<b>HA</b>	Brass-Plated	<b>NN</b>	Metallic Beige	<b>ZY</b>	Titanium
<b>HH</b>	Tropicalized	<b>NO</b>	Beige	<b>ZZ</b>	Clear
<b>HL</b>	Raw Brass	<b>OA</b>	Oak	<b>00</b>	Insignificant finish
<b>HX</b>	Graphite	<b>OZ</b>	Ash		
<b>IA</b>	Grey	<b>PA</b>	Light Ash		

## TRIADE MINI

**TRIADE MINI** is the concealed mounting bracket for shelves 25 mm thick. It has been conceived to simplify the shelf installation. It is provided with three independent adjustments:

### 1) VERTICAL

Before installing the shelf, the mounting brackets can be adjusted in height and (vertically) aligned through the slots.

### 2) HORIZONTAL

While placing the shelf in position, the supporting pins can be slid horizontally.

### 3) INCLINATION

When the shelf is partially inserted, the shelf angle can be adjusted front to back by turning the supporting pins with a 12mm open-ended wrench.

The capacity loading is 4,5Kg each (shelf weight included) for a shelf max 200mm deep.

Shelf minimum depth: 165mm

Zinc alloy and steel

25 mm min.



4,5 kg for each shelf support  
for shelf 200 mm deep



PAT. PENDING



## INSTALLATION AND ADJUSTMENTS

### WOOD PANEL

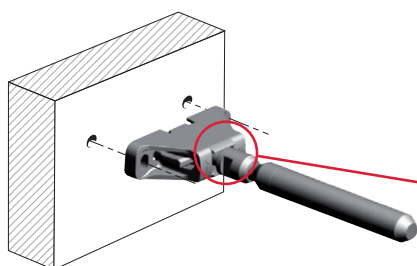

Recommended fixing pan head  
screw type - head Ø 5 mm max.

### SOLID AND PLASTERBOARD PANEL

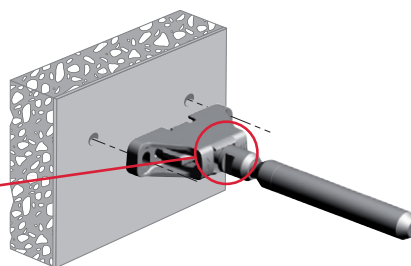

### VERY IMPORTANT

Triade Mini has to be installed  
with the arrow facing upwards.

It is the responsibility of the customer:

- to ensure the wall is of a suitable quality to hold the shelf fixing in place.
  - to use the proper hardware fittings according to the construction of the
- For more specific information, please refer to the WARNINGS section at the end of the catalogue.

### BRACKET ALIGNMENT

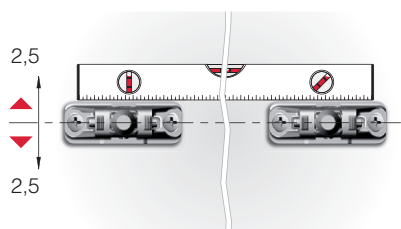

### LATERAL ADJUSTMENT

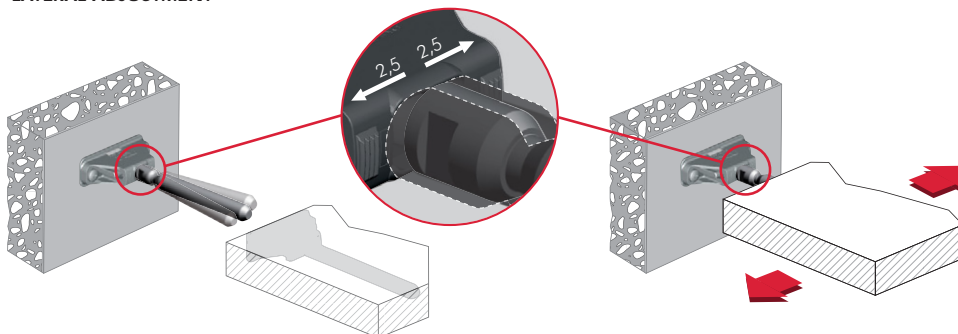

### INCLINATION ADJUSTMENT

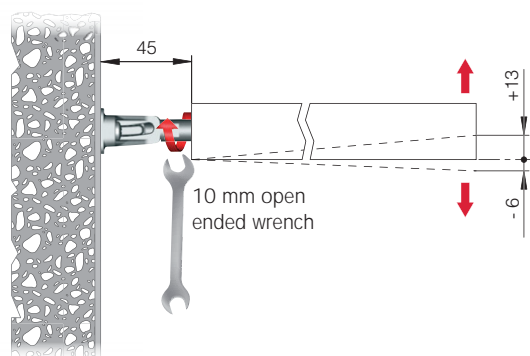

### COMBINATION SHELF LOAD AND SHELF DEPTH

(The figures refer to 1 shelf support)

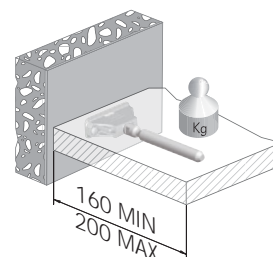
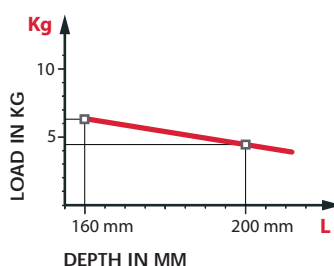

+ shelf weight = 4,5 kg  
MAX for each shelf support

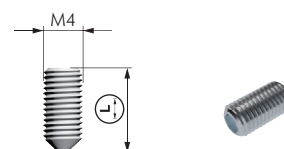
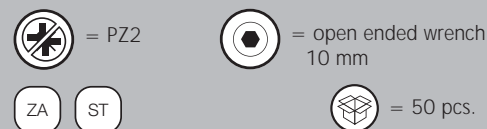
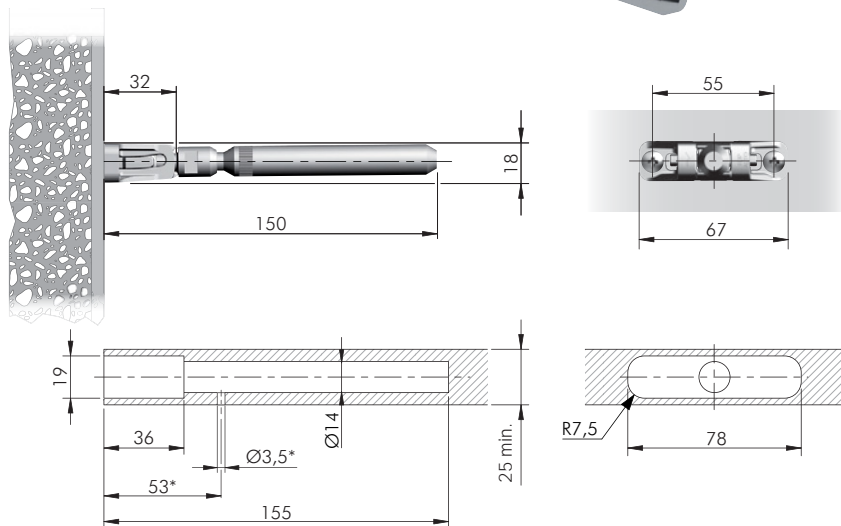

\* Optional drilling for security locking with M4 grub screw placed underneath in alignment with the cavity.

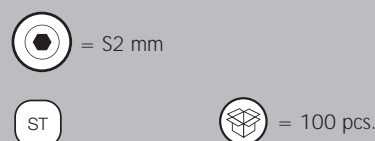
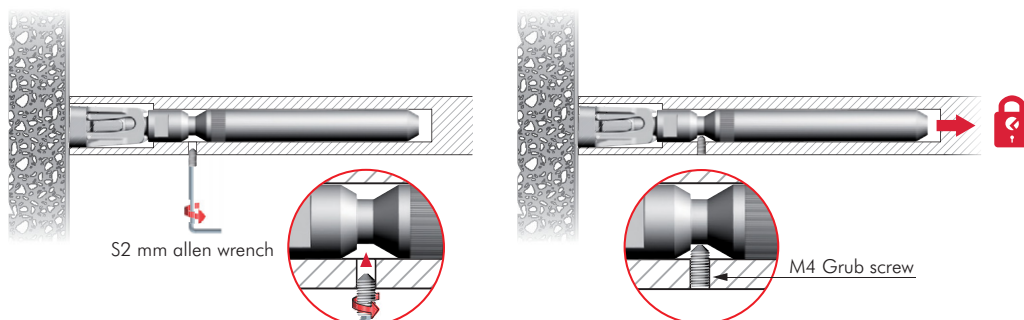

## DRILL BIT FOR TRIADE MINI

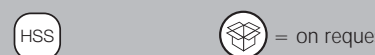
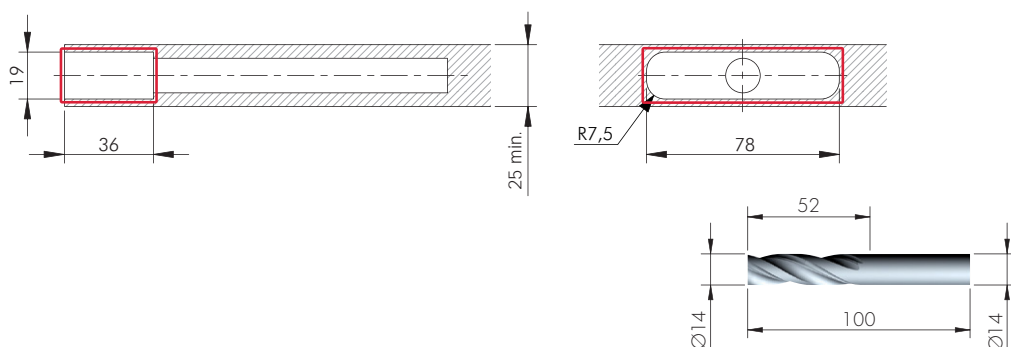
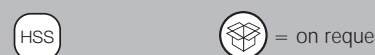
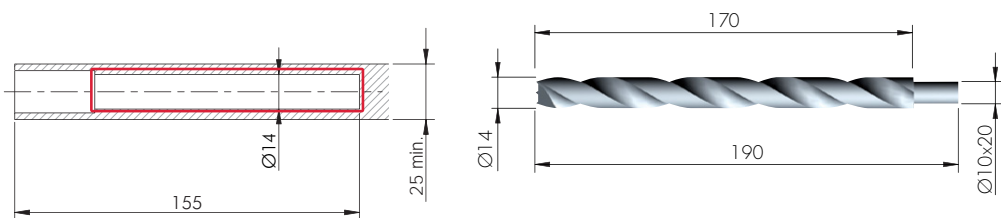

## TRIADE MINI AND BRACKET

**BRACKET FOR TRIADE MINI** with pin Ø 8mm is a valid complement to the concealed shelf support Triade Mini for shelves 25mm thick.

It is strongly recommended to be used in combination with the Triade Mini for shelves over 200mm deep, in order to improve the shelf support capacity loading, by evenly distributing the shelf load on the wall through a pin.

The Ø 8mm pin allows to reduce the load taken by the two fixing screws.

The capacity loading is 10Kg each (shelf weight included) for a shelf max 300mm deep.

Shelf minimum depth: 165mm

Zinc alloy and steel

25 mm min.



10 kg for each shelf support  
for shelf 300 mm deep



PAT. PENDING



### INSTALLATION

#### SOLID AND PLASTERBOARD PANEL

#### VERY IMPORTANT

Triade Mini has to be installed  
with the arrow facing upwards.

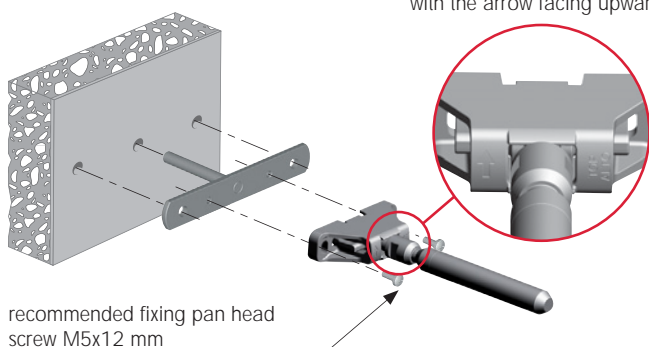

recommended fixing pan head  
screw M5x12 mm

#### COMBINATION SHELF LOAD AND SHELF DEPTH

(The figures refer to 1 shelf support)

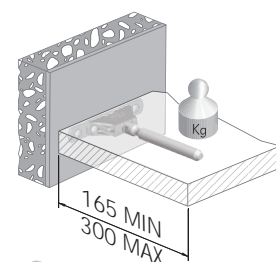
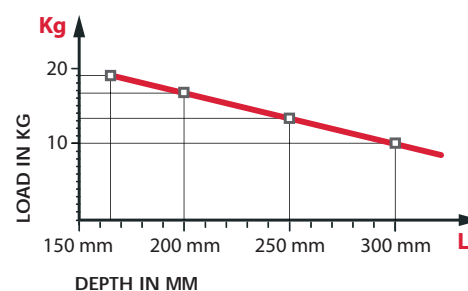

+ shelf weight = 10 kg  
MAX for each shelf support

It is the responsibility of the customer:

- to ensure the wall is of a suitable quality to hold the shelf fixing in place.
- to use the proper hardware fittings according to the construction of the wall.

For more specific information, please refer to the WARNINGS section at the end of the catalogue.

#### VERY IMPORTANT

- The capacity loading data stated in the chart refers to Triade Mini used in combination with the related wall bracket.

- It is strongly recommended to use the triade mini in combination with the related wall bracket, otherwise Italiana Ferramenta will not be held responsible for any failure.

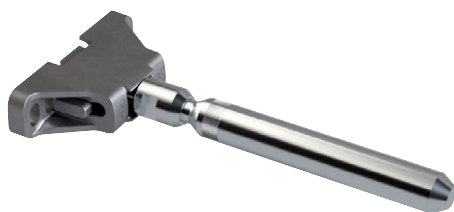

= PH2



= open ended  
wrench 10 mm

ZA

ST



= 50 pcs.



1621401000



= M5



= 100 pcs.

ST



16215040ZN



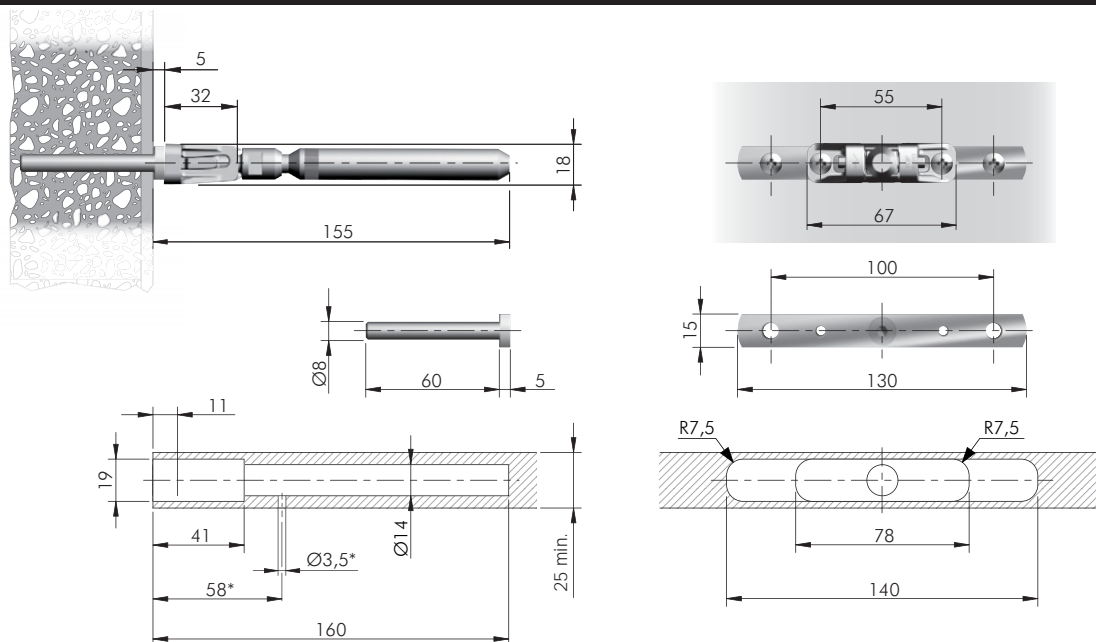

\* Optional drilling for security locking with M4 grub screw placed underneath in alignment with the cavity. For details refer to Triade Mini section.

## TRIADE MINI BRACKET FIXING ACCESSORY

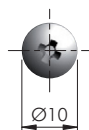
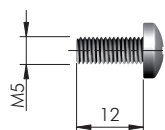

= M5



= PZ2



= 7000 pcs.



ST



= 7000 pcs.



60334030ZN

## DRILL BIT FOR TRIADE MINI AND BRACKET

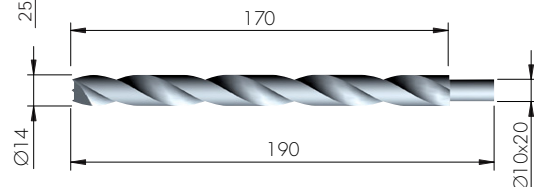
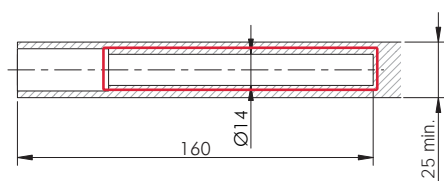

HSS



= on request



1621452000

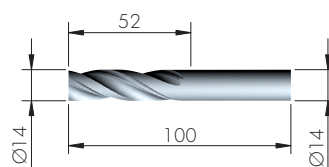
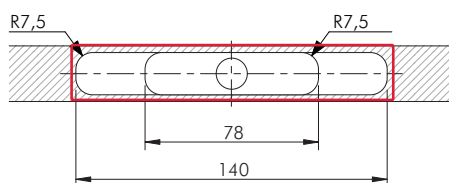
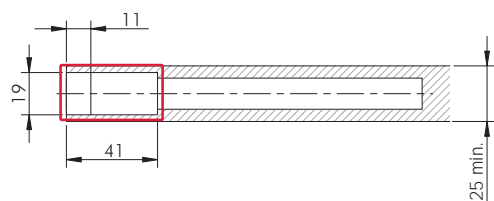

HSS



= on request



1621454000



## APPLICATION FOR ALL TRIADE VERSIONS

### VERTICAL ADJUSTMENTS

#### RELEASE THE FIXING SCREWS

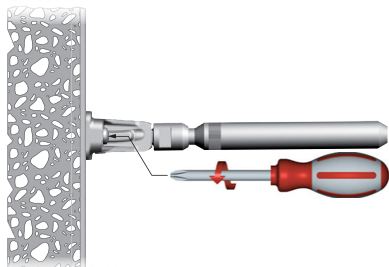

#### ALIGN BRACKETS VERTICALLY ACCORDINGLY

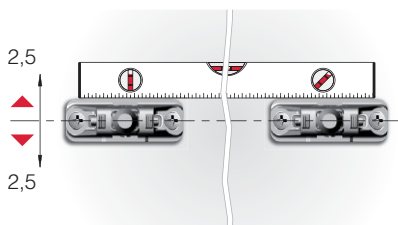

#### TIGHT THE FIXING SCREWS

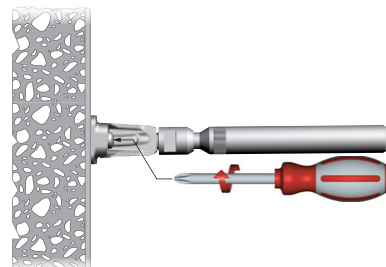

### SHELF INSERTING AND LATERAL ADJUSTMENT

#### TILT THE SHELF TO MATCH BOTH SUPPORTING PINS AND SHELF HOUSINGS

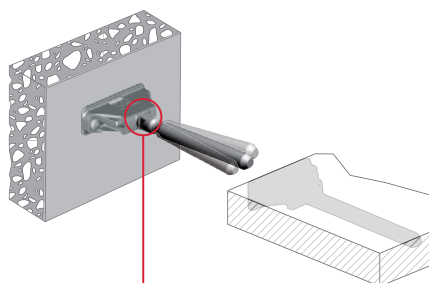

#### INSERT PARTIALLY THE SHELF

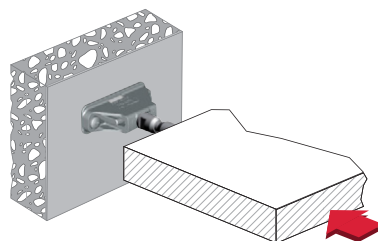

#### ADJUST THE SHELF Laterally ACCORDING TO THE APPLICATION (i.e. MULTI-SHELF COMPOSITION)

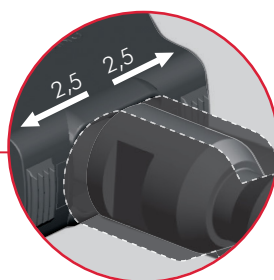
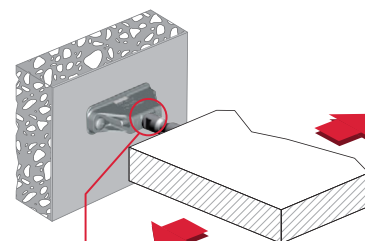

### INCLINATION ADJUSTMENTS

#### TURN CLOCKWISE THE SUPPORTING PIN WITH A 10 - 12 mm OPEN-ENDED WRENCH TO ADJUST THE SHELF ANGLE FRONT TO BACK ACCORDINGLY

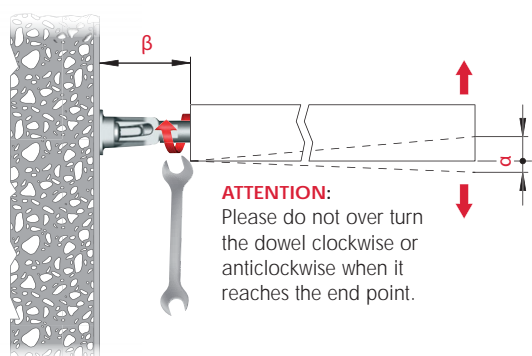

MODEL	$\beta$ (mm)	$\alpha$ (mm)
TRIADE MINI	approx. 45	-6 +13
TRIADE	approx. 45	-6 +13
TRIADE MAXI	approx. 70	-8 +20
TRIADE XXL	approx. 70	-8 +20

#### SCREW THE LOCKING BOLT TO BLOCK THE PIN

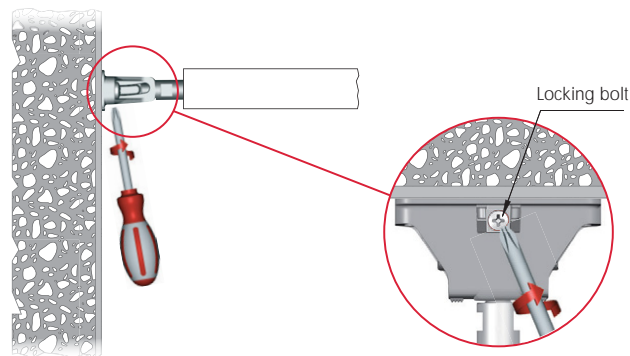

### SHELF INSERTING FOR ALL TRIADE MODELS

#### PUSH THE SHELF AGAINST THE WALL UNTIL THE END

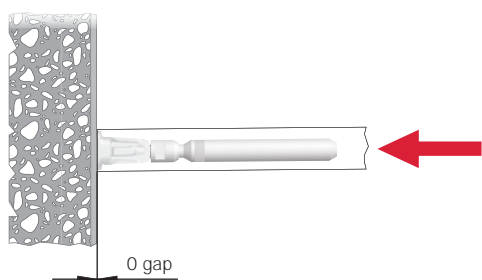





## DRILLING JIG FOR TRIADE

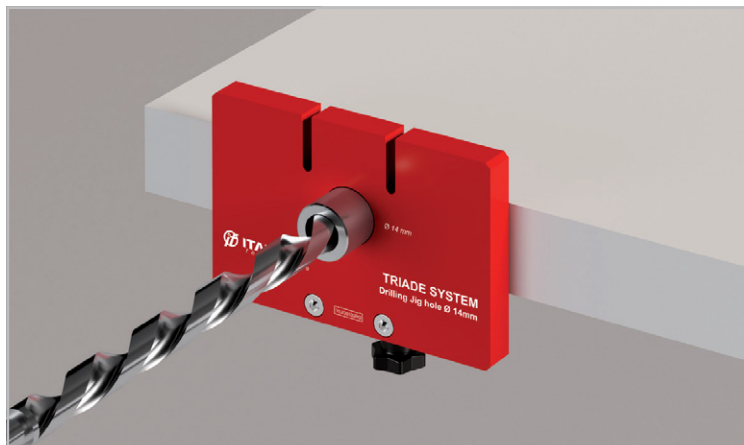

50 mm MAX 



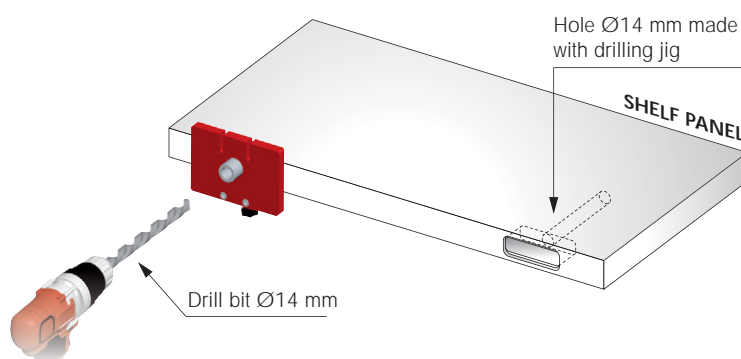
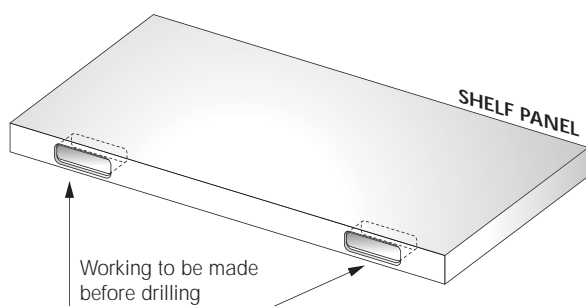

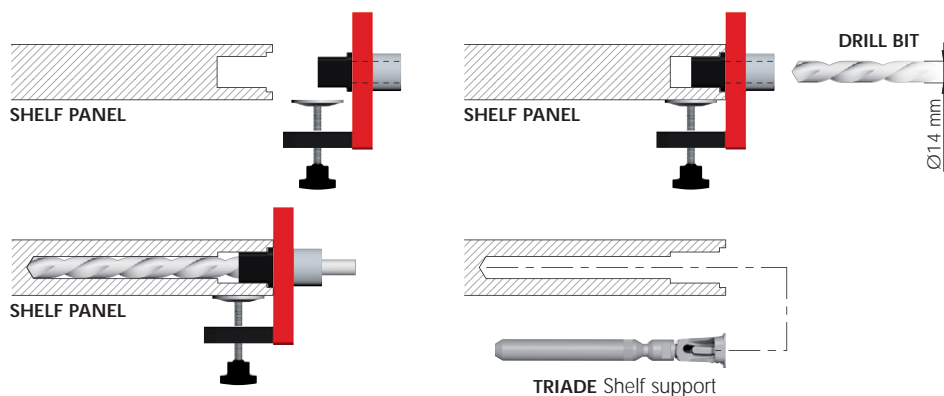
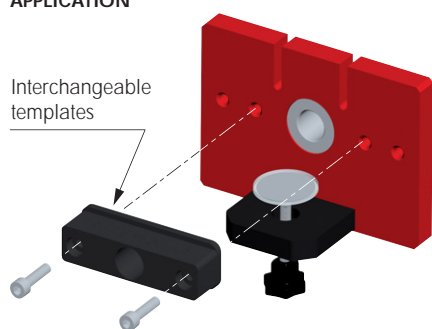

### GENERAL SPECIFICATIONS

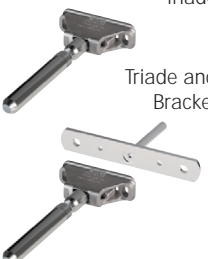

### APPLICATION



### TEMPLATES AVAILABLE

<b>TEMPLATE FOR TRIADE MINI</b> Part no. Y0JG013500	<b>TEMPLATE FOR TRIADE</b> Part no. Y0JG013600	<b>TEMPLATE FOR TRIADE MAXI</b> Part no. Y0JG013700	<b>TEMPLATE FOR TRIADE MINI</b> Part no. Y0JG013800	<b>TEMPLATE FOR TRIADE MAXI</b> Part no. Y0JG013900
Triade Mini 	Triade 	Triade Maxi 	Aluminium profile for Triade Mini and Triade  Triade Mini 	Aluminium profile for Triade Maxi  Triade Maxi 

## TRIADE DRILLING JIG



## TRIADE DRILLING JIG TEMPLATES

### TRIADE MINI DRILLING PLAN

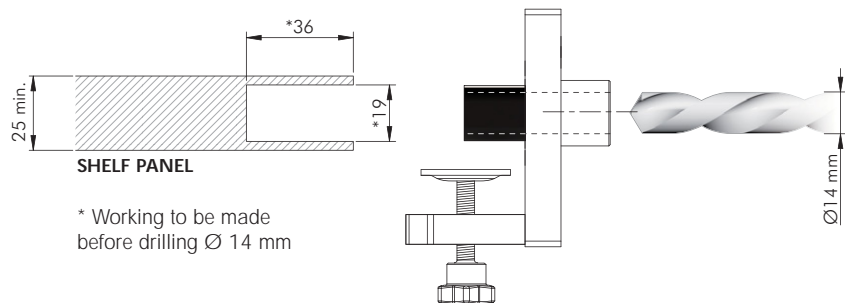

### TRIADE MINI AND BRACKET DRILLING PLAN

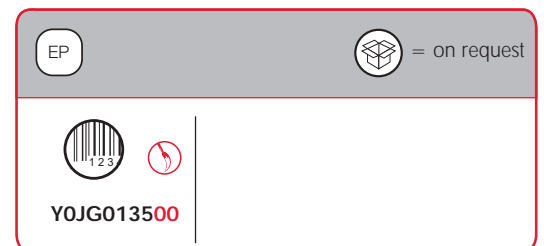
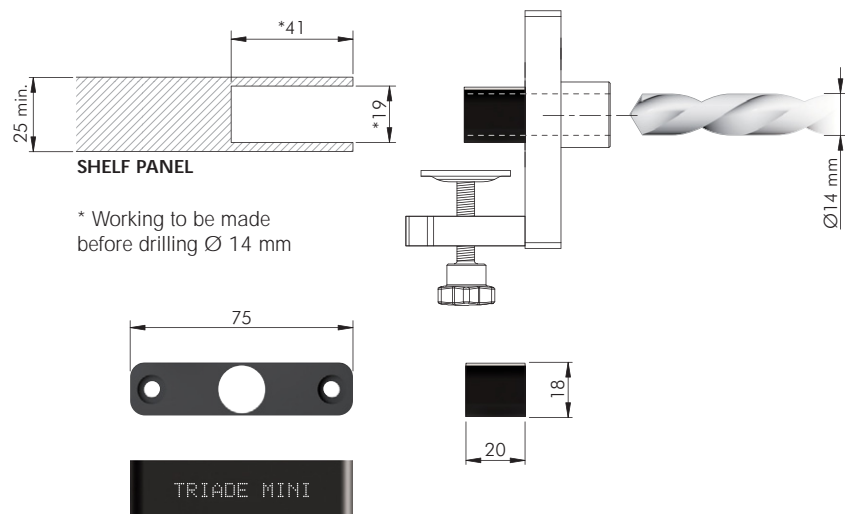

NOTE: The product code includes the fixing screws.





## TRIADE DRILLING PLAN

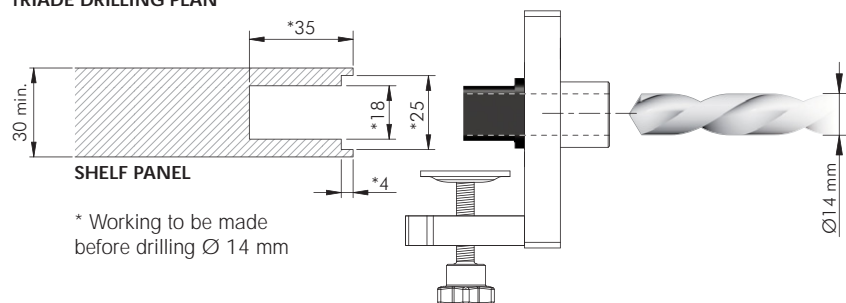

\* Working to be made  
before drilling Ø 14 mm

## TRIADE AND BRACKET DRILLING PLAN

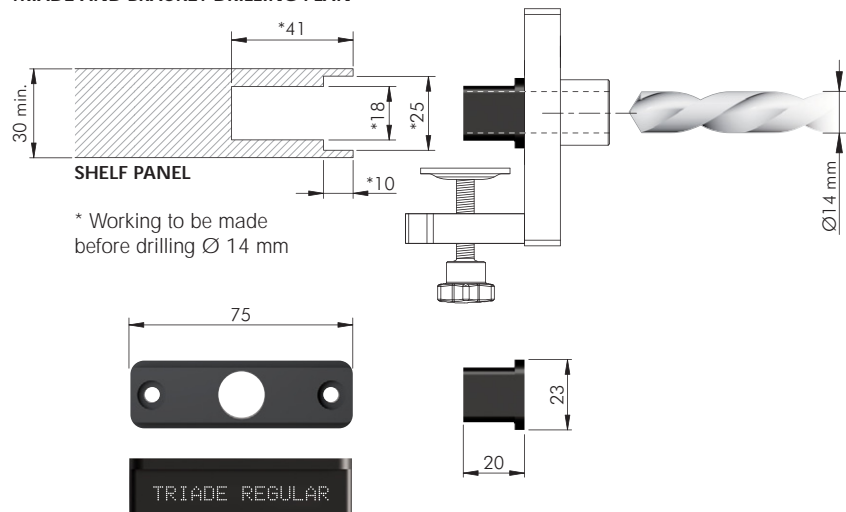

\* Working to be made  
before drilling Ø 14 mm

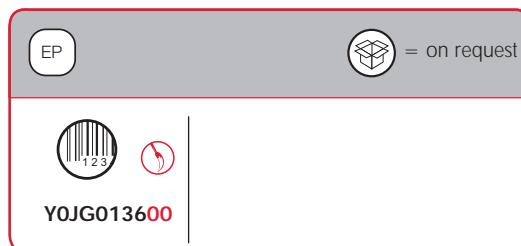

NOTE: The product code includes the fixing screws.



TRIAD MAXI DRILLING PLAN

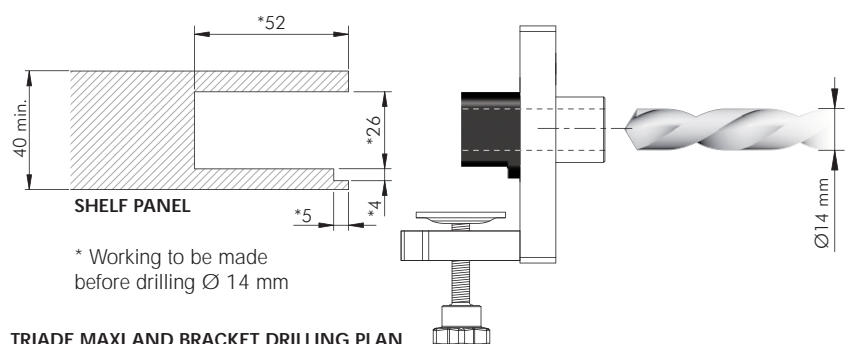

\* Working to be made  
before drilling Ø 14 mm

### TRIADE MAXI AND BRACKET DRILLING PLAN

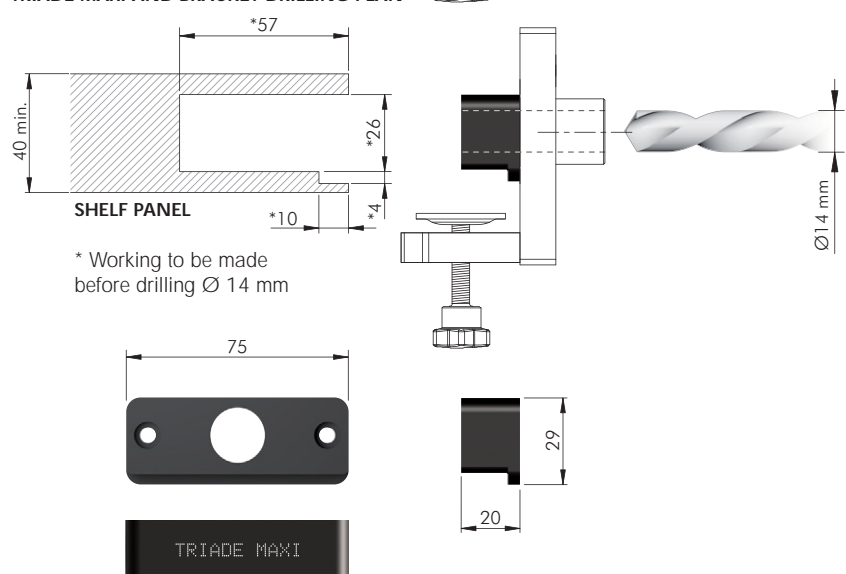

\* Working to be made  
before drilling Ø 14 mm

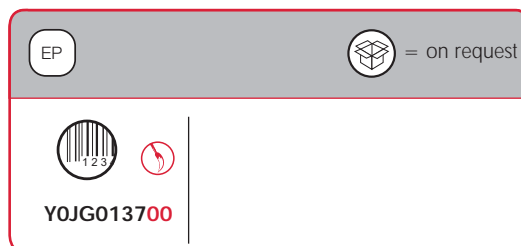

NOTE: The product code includes the fixing screws.



## TRIADE MINI WITH ALU PROFILE DRILLING PLAN

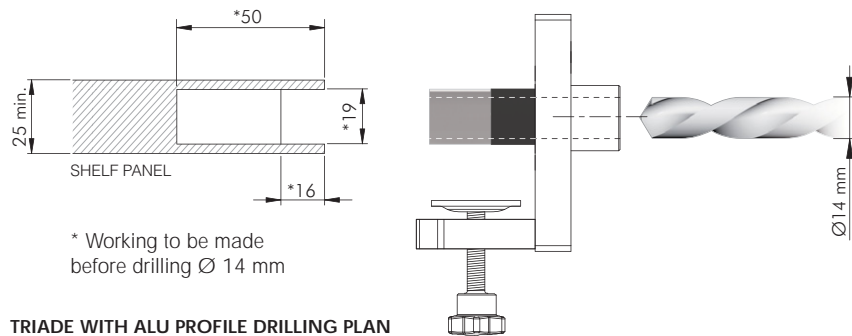

## TRIADE WITH ALU PROFILE DRILLING PLAN

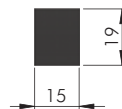
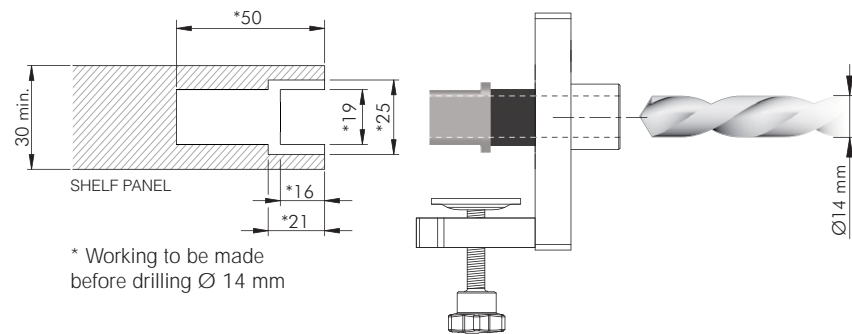

ALUMINIUM PROFILE TRIADE MINI  
TRIAD E REGULAR

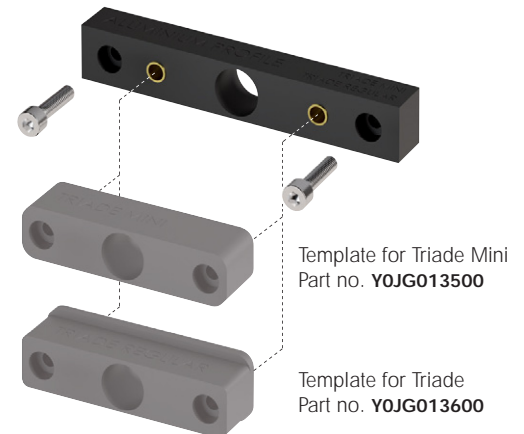
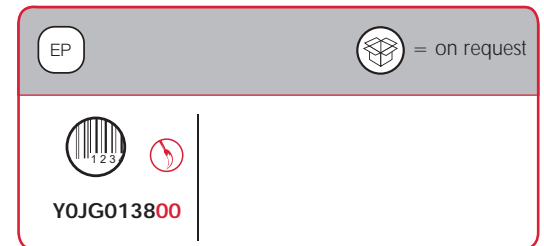

## TRIADE MAXI DRILLING PLAN

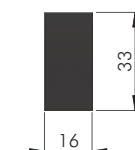
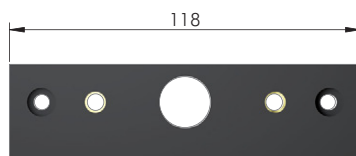
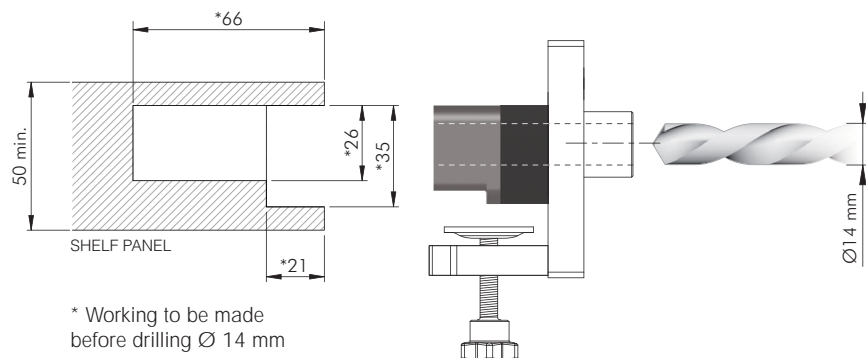

ALUMINIUM PROFILE TRIADE MAXI

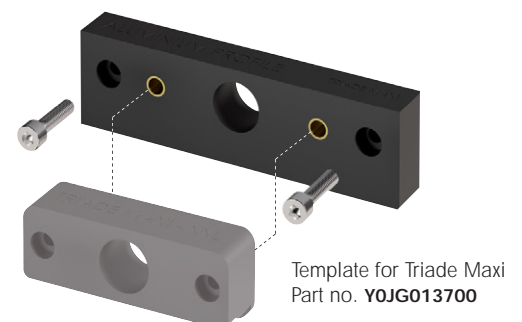
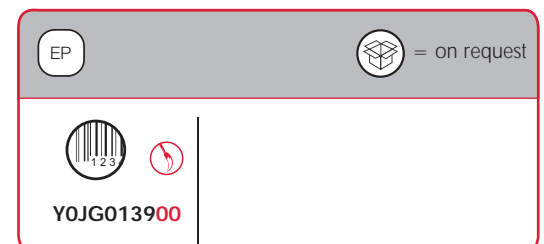



## DRILL BIT

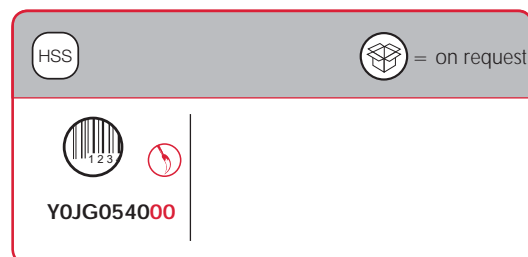
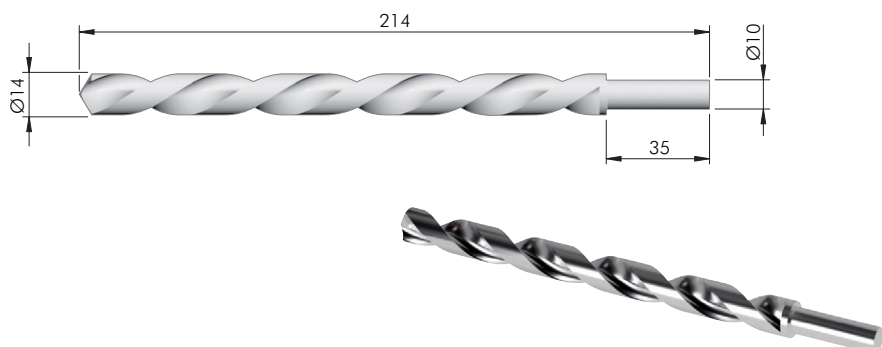

NOTE: For drilling jig we recommend to use precision-ground steel drill bit HSS-G.

## COMPLETE KIT DRILLING JIG FOR TRIADE

CONTENT OF THE CASE:

Part no.	Part no.
Y0JG0130RO	Y0JG0133RO
Y0JG013500	Y0JG054900
Y0JG013600	Y0JG055000
Y0JG013700	Y0JG054000
Y0JG013800	Y0JG054100
Y0JG013900	



## BASE KIT DRILLING JIG TRIADE AND DRILL BIT (only template for Triade Regular)

CONTENT OF THE CASE:

Part no.
Y0JG0130RO
Y0JG013600
Y0JG054000

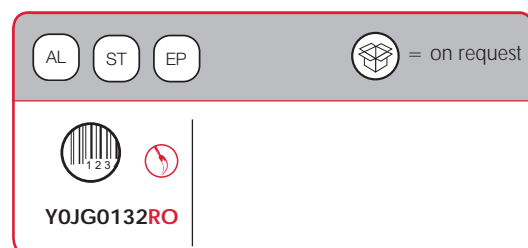
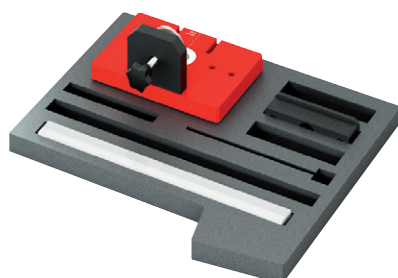

## TRIADE DRILLING JIG INSERT FOR SECURITY LOCKING



### GENERAL SPECIFICATIONS

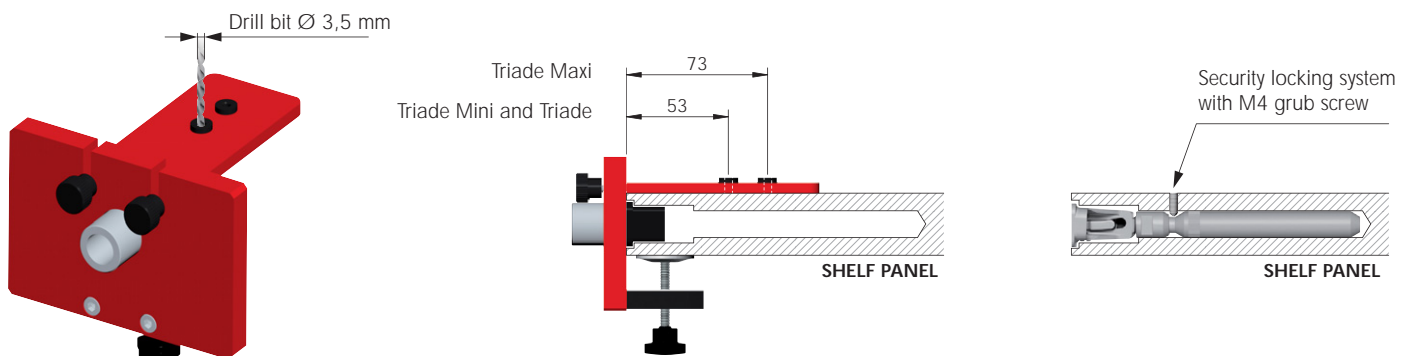
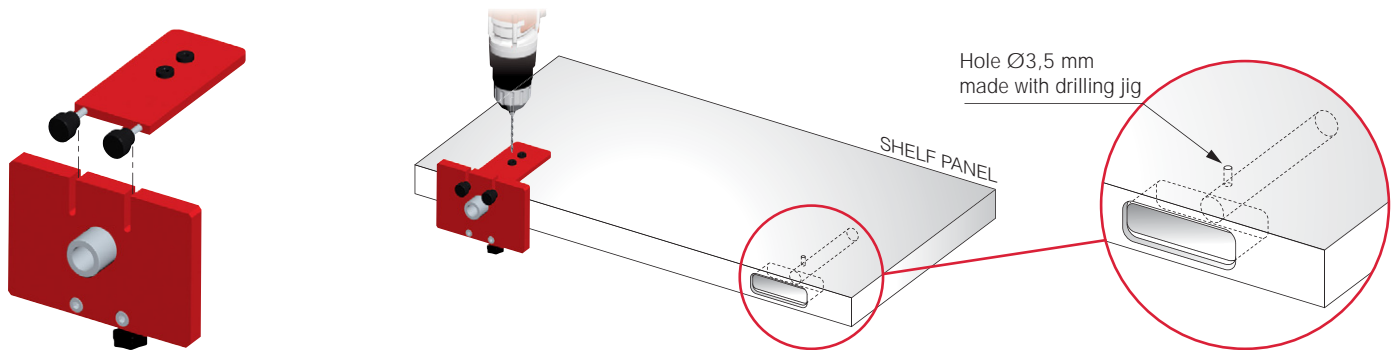

### SPACERS AVAILABLE

#### SPACER FOR TRIADE WALL BRACKETS

Part no. Y0JG054900

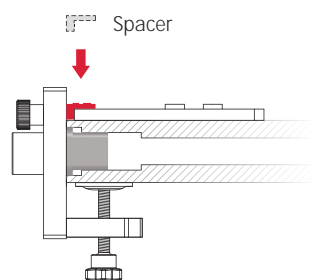
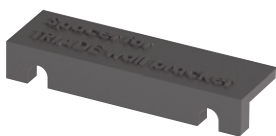

#### SPACER FOR TRIADE ALUMINIUM PROFILES

Part no. Y0JG055000

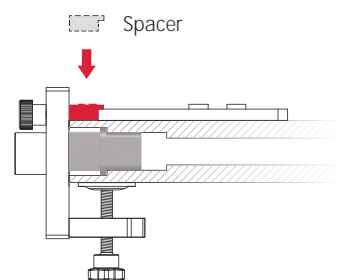
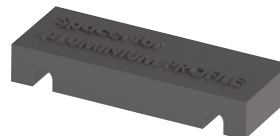





## DRILLING JIG INSERT FOR SECURITY LOCKING



## SPACERS FOR SECURITY LOCKING

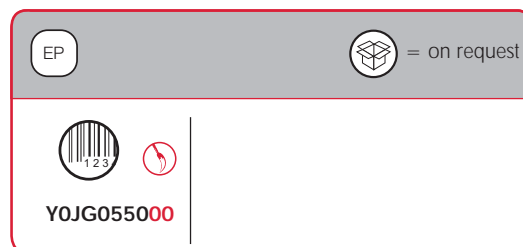
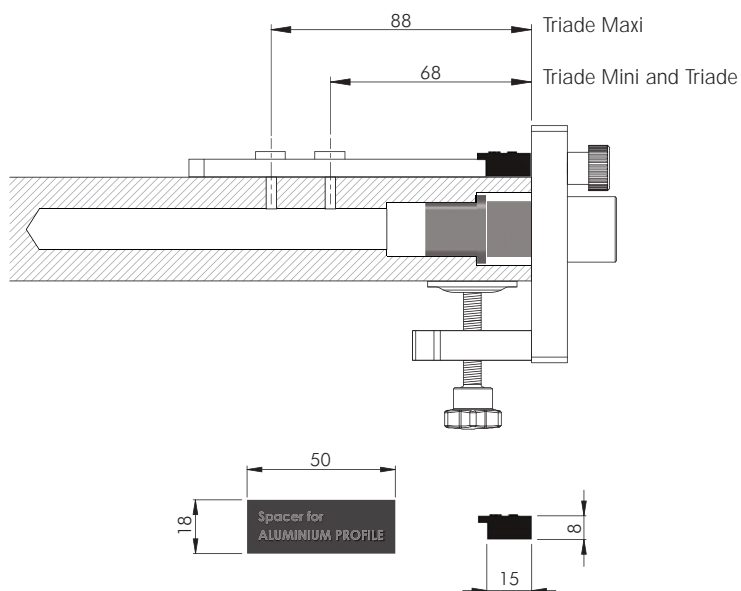
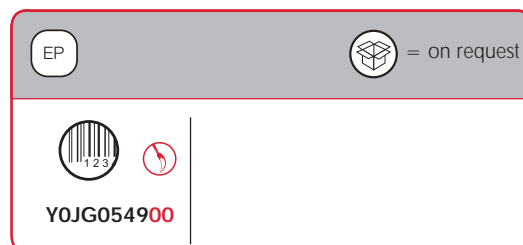
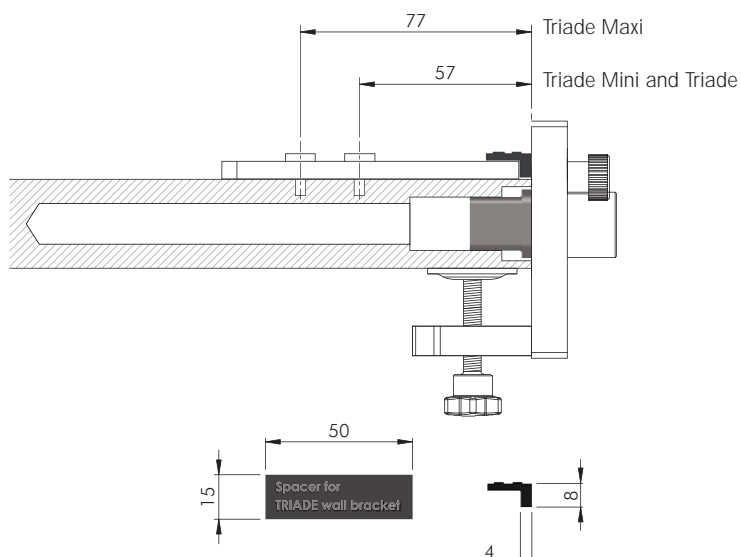

## DRILL BIT

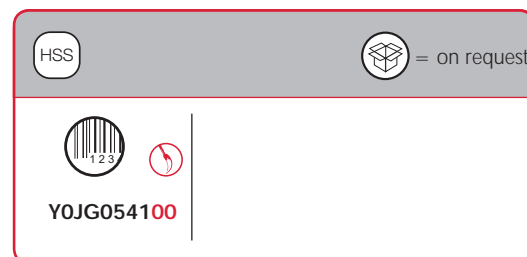
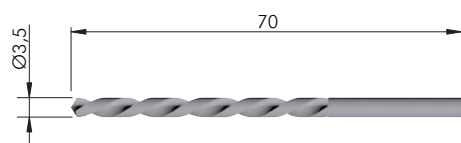

NOTE: For drilling jig we recommend to use precision-ground steel drill bit HSS-G.

## COMPLETE SET DRILLING JIG FOR TRIADE

CONTENT OF THE CASE:

Part no.	Part no.
Y0JG0130RO	Y0JG0133RO
Y0JG013500	Y0JG054900
Y0JG013600	Y0JG055000
Y0JG013700	Y0JG054000
Y0JG013800	Y0JG054100
Y0JG013900	



## SET WITH DRILLING JIG TRIADE AND DRILL BIT Ø14 mm (only template for Triade Regular)

CONTENT OF THE CASE:

Part no.
Y0JG0130RO
Y0JG013600
Y0JG054000

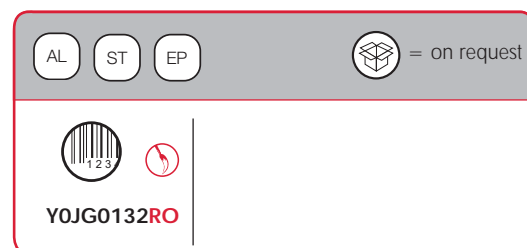
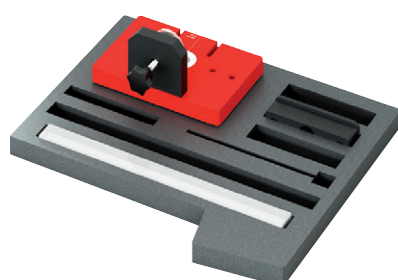



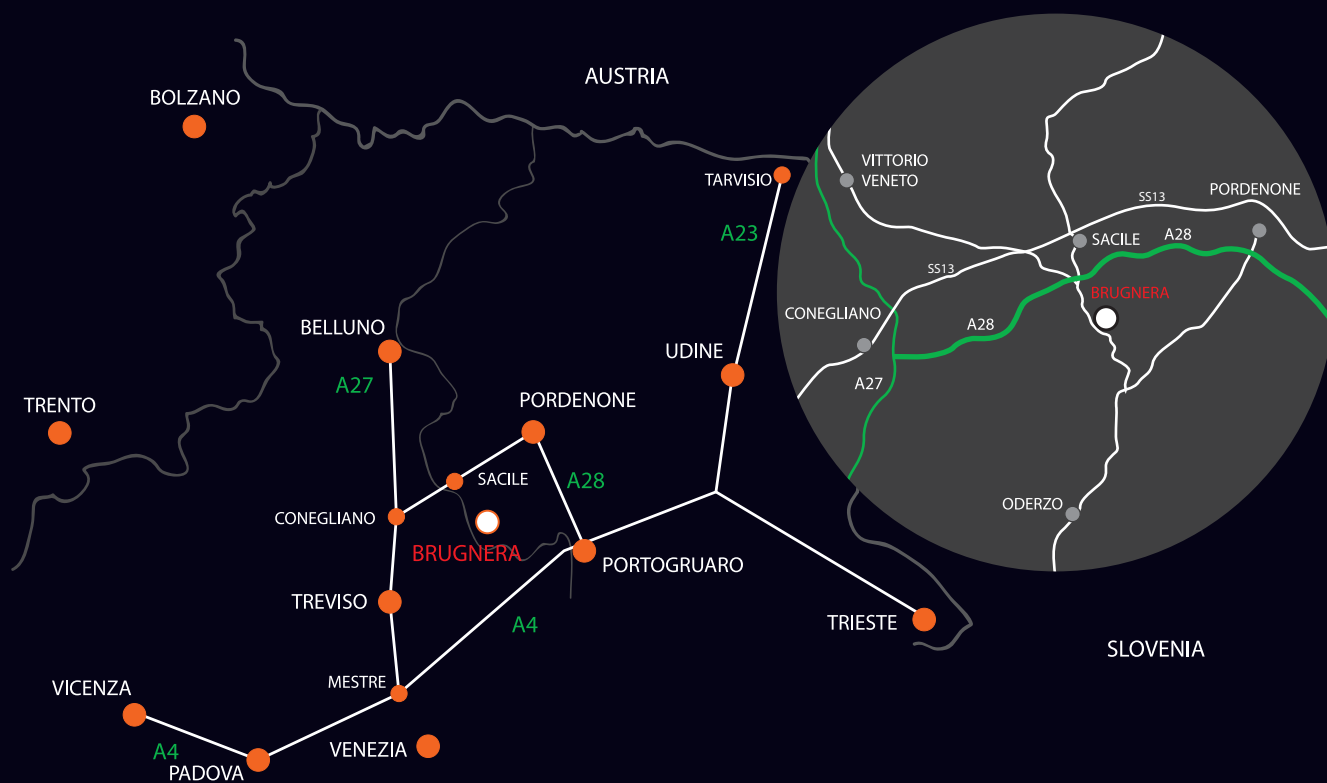

[www.italianaferramenta.com](http://www.italianaferramenta.com)